

THE ROYAL HORSEGUARDS HOTEL

ONE WHITEHALL PLACE



MEETINGS & EVENTS





National Liberal Club Rooms
DAVID LLOYD GEORGE ROOM
LADY VIOLET ROOM
LAWRENCE ROBSON ROOM
SMOKING ROOM
Savage Club On Ground Floor
One Whitehall Place Rooms
READING & WRITING
GLADSTONE LIBRARY
RIVER ROOM
MESTON SUITE
WHITEHALL SUITE
WHITEHALL RECEPTION
CELLAR

NATIONAL
LIBERAL CLUB
MEMBERS
ONLY

ONE WHITEHALL PLACE

Home to many of the political and literary greats of 19th and 20th century British society, there are few venues in London as prestigious as One Whitehall Place.

Arranged over two of the four spectacular floors, its magnificent rooms are reached by an awe-inspiring, circular, self standing marble staircase, the largest of its kind in Europe.

One Whitehall Place is within easy reach of all the key business centres, tourist attractions, cultural landmarks and transport links.





THE GLADSTONE LIBRARY

Our largest function room – the Gladstone Library – features a wealth of architectural detail.

The essence of the original library remains intact, through faithful replicas of the 30,000 volumes that surround the room. The high ceilings, magnificent faience tiled columns and windows flooded with natural light enhance the impressive Victorian grandeur, setting the perfect scene for any type of event.

The Gladstone Library interconnects to the Reading & Writing Room.

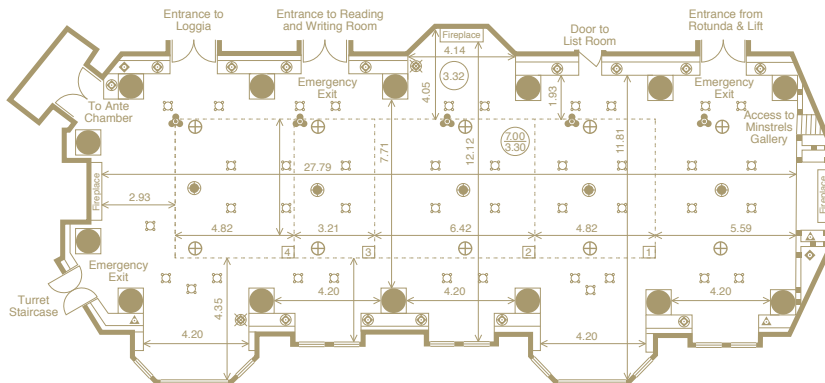

	The Gladstone Library
Boardroom	80
Theatre	240
U-Shape	80
Cabaret	170
Banqueting	228
Classroom	180
Reception	350



THE READING & WRITING ROOM

As the name suggests, the Reading & Writing Room was an oasis of peace in which to withdraw from the hustle and bustle of political life.

The Reading & Writing Room boasts some of London's best views over the River Thames, London Eye and the adjacent award-winning Whitehall Gardens. This is the perfect space for receptions, exhibitions and elegant dinners.

The Reading & Writing Room interconnects to the Gladstone Library.

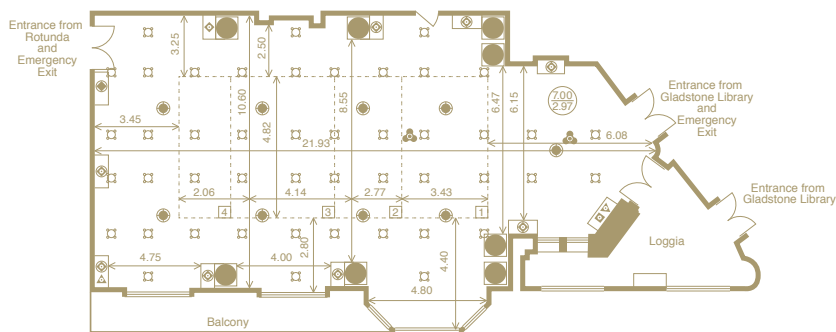

	The Reading & Writing Room
Boardroom	64
Theatre	144
U-Shape	40
Cabaret	120
Banqueting	150
Classroom	100
Reception	250

THE RIVER ROOM

The River Room still displays its original oak panelling, while the floor to ceiling windows reveal stunning, all-encompassing views towards the London Eye and River Thames.

The quintessential setting for a private dinner with a fabulous backdrop.



	The River Room
Boardroom	30
Theatre	70
U-Shape	32
Cabaret	50
Banqueting	72
Classroom	50
Reception	70

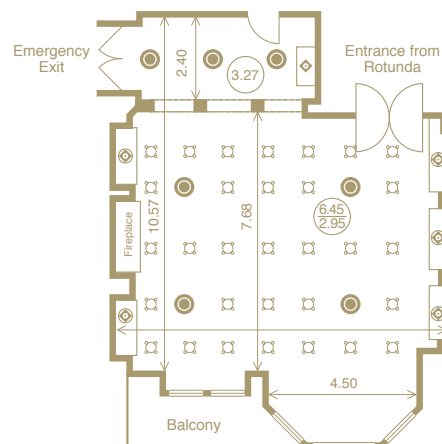



THE MESTON SUITE

The Meston Suite overlooks some of Whitehall's finest architecture. With its white walls and magnificent floor to ceiling windows, the Meston Suite is flooded with natural daylight.

An architectural jewel that lends itself to all types of events, meetings and dinners.

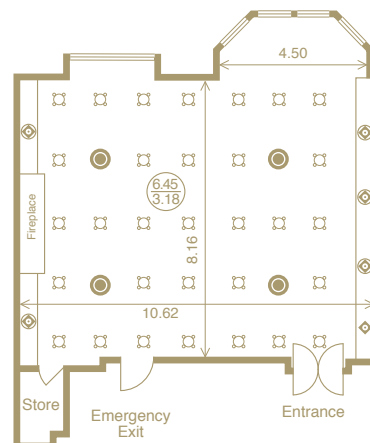

	The Meston Suite
Boardroom	30
Theatre	70
U-Shape	32
Cabaret	50
Banqueting	72
Classroom	50
Reception	70



THE WHITEHALL SUITE

Formerly the billiards room for the Club, The Whitehall Suite displays some of the finest examples of intricate faience tiling on its splendid columns. The room also contains the original balcony from where the ladies could sit and watch the gentlemen play billiards and conduct business.

The Whitehall Suite offers an elegant yet spacious room, perfect for presentations, conferences – with or without back projection – and prestigious events.

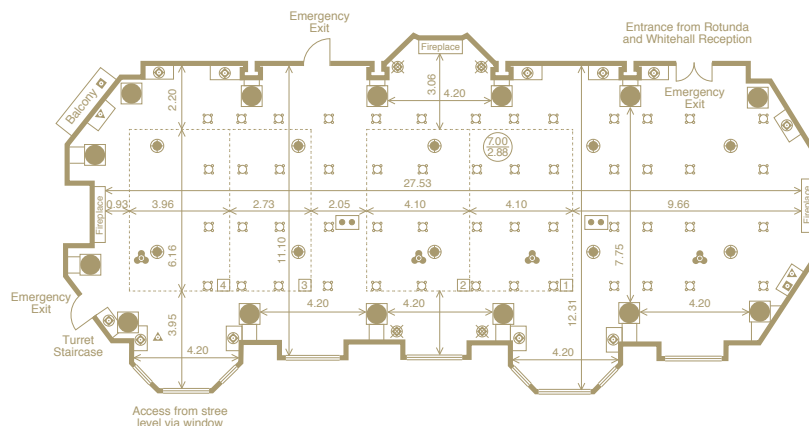

	The Whitehall Suite
Boardroom	80
Theatre	240
U-Shape	75
Cabaret	170
Banqueting	228
Classroom	180
Reception	250

THE WHITEHALL RECEPTION

Perfectly situated, the Whitehall Reception provides a number of options in conjunction with the Whitehall Suite. The Reception room also divides into 3 separate flexible spaces to cater for all your needs, whether for numerous simultaneous meetings or dining options.



	The Whitehall Reception
Boardroom	42
Theatre	84
U-Shape	42
Cabaret	40
Banqueting	120
Classroom	54
Reception	150

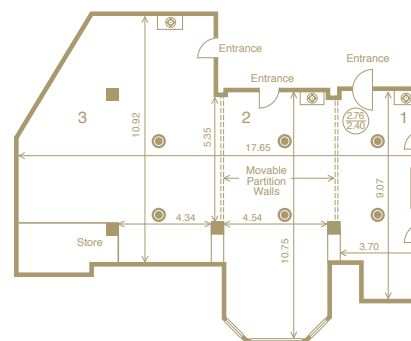



THE CELLAR

The Cellar is steeped in history. During both World Wars, One Whitehall Place was used by the Intelligence Service as its headquarters. According to local legend, an underground passage once ran from The Cellar under Horse Guards Avenue to the Ministry of Defence, and Whitehall. A dynamic and diverse space, it is perfect for intimate private parties, supper clubs, product launches and small bespoke events.

The Cellar can accommodate up to 70 people.

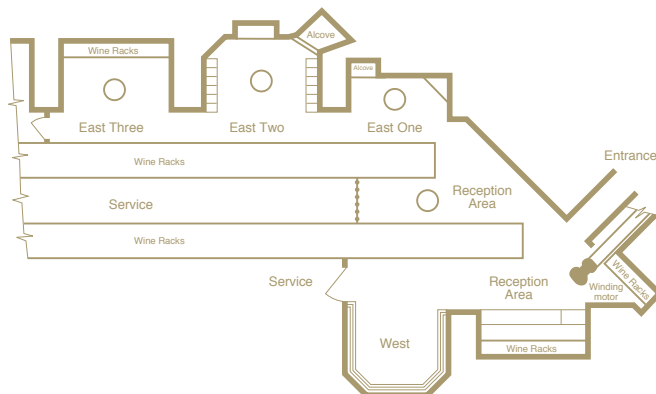

	The Cellar
Boardroom	-
Theatre	-
U-Shape	-
Cabaret	-
Banqueting	12
Classroom	-
Reception	80

CHURCHILL'S BAR

Sir Winston Churchill was one of the greatest political figures in British history. So it is only appropriate that the bar, based in the club where he spent so much of his time meeting, debating and relaxing, should bear his name.

With its opulent décor, with a distinct modern twist, and an excellent range of wines, spirits and cocktails, the Churchill Bar is the ideal venue for post-dinner drinks, private parties up to 70 people and intimate get-togethers demanding peace and privacy, yet within easy reach of all the larger event spaces.





THE ROYAL HORSEGUARDS HOTEL

Adjoining One Whitehall Place, the award-winning The Royal Horseguards hotel offers 5-star luxury, superb facilities and the ultimate client service to complement your event requirements.

This truly British hotel offers the latest in state-of-the-art technology and boasts 282 perfectly appointed bedrooms and suites, many with beautiful river and city skyline views.

The Royal Horseguards also has six state-of-the-art event suites. Ideal for an array of functions and events for up to 40 guests, they are perfect for hosting private dinners, boardroom meetings and drinks receptions.

THE EXECUTIVE BOARDROOM

This beautifully appointed room, with built-in plasma screen and communications, is ideal for private board meetings for up to 10 people. Flooded with natural daylight, it is the ultimate setting for all-day meetings, and can easily be adapted into a luxurious, yet discreet, private dinner space.



	The Executive Boardroom
Boardroom	10
Theatre	-
U-Shape	-
Cabaret	-
Banqueting	10
Classroom	-
Reception	-

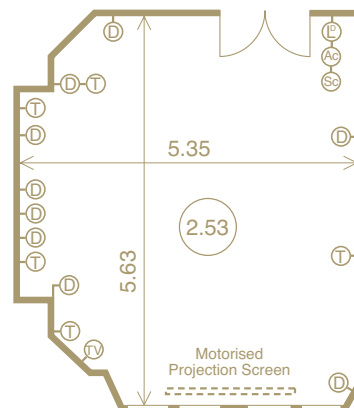



THE THAMES SUITE

Overlooking the Terrace, this bright and versatile room is ideal for board meetings, training events, lunches or dinners for up to 30 people.



	The Thames Suite
Boardroom	24
Theatre	40
U-Shape	18
Cabaret	32
Banqueting	40
Classroom	24
Reception	50

THE CHELSEA SUITE

The Chelsea Suite is an ideal room for hosting receptions, lunches and dinners for up to 30 people. Interlinking with the Terrace Room and its outside Terrace, the Chelsea Suite provides an extended flexible space for any event.



	The Chelsea Suite
Boardroom	24
Theatre	40
U-Shape	-
Cabaret	24
Banqueting	30
Classroom	20
Reception	40

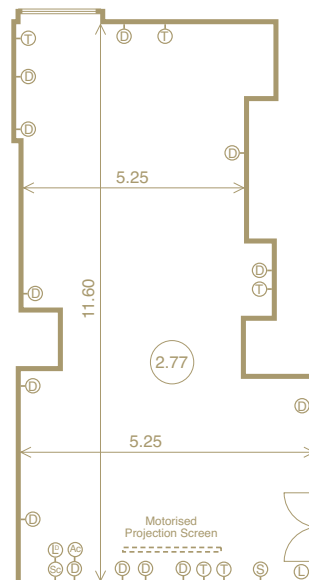



THE WATERLOO SUITE

An intimate setting in the elegant surroundings of the main hotel, the Waterloo Suite lends itself to small to medium business meetings, dinners or as an additional syndicate or press room.

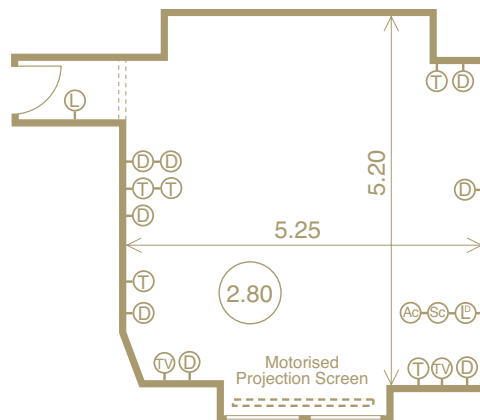

	The Waterloo Suite
Boardroom	14
Theatre	-
U-Shape	-
Cabaret	-
Banqueting	14
Classroom	-
Reception	20

THE LONDON ROOM

Working in conjunction with the adjacent One Twenty One Two fine dining restaurant, the London Room is the perfect private dining room. It is also ideal for board meetings.



	The London Room
Boardroom	14
Theatre	-
U-Shape	-
Cabaret	-
Banqueting	14 (long table)
Classroom	-
Reception	25

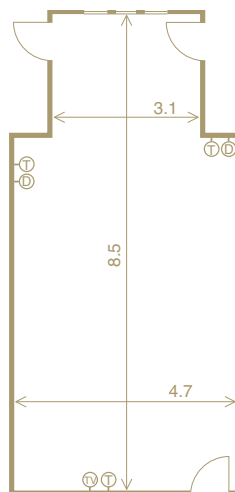



THE TERRACE ROOM

The Terrace Room connects with the outside Terrace, the Chelsea Suite and the One Twenty One Two fine dining restaurant. A versatile space, with beautiful natural daylight, it is the ultimate private events area.

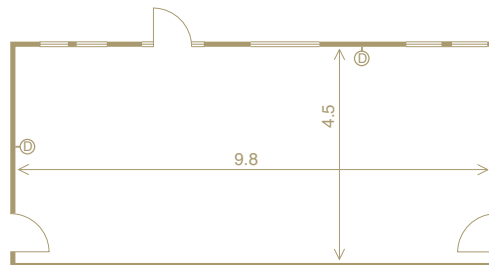

	The Terrace Room
Boardroom	22
Theatre	-
U-Shape	-
Cabaret	-
Banqueting	30 (long tables)
Classroom	-
Reception	50





THE TERRACE

The delightful exterior Terrace provides a secluded haven of tranquility, where one can enjoy alfresco dining or simply a quiet drink. Away from the hustle and bustle of London life, the hotel's exterior provides a stunning backdrop – perfect for watching the sun set over the London skyline and the London Eye on the River.

The Terrace is also available for hire all year round. A perfect spot for a summer barbecue or alfresco cocktails, the Terrace can also be sectioned off as required, making it a most flexible outdoor venue, with direct access to the award-winning Whitehall Gardens, plus the adjoining Terrace Room and One Twenty One Two restaurant.

ONE TWENTY ONE TWO

Our fine-dining restaurant, One Twenty One Two, offers an award-winning modern British cuisine experience, using superlative ingredients sourced from around the British Isles.

Able to host tables of up to 10 guests, it is named after the telephone number of the hotel's former neighbour, Scotland Yard. This restaurant continues to build a growing reputation in the Capital.



ONE
*Twenty
one*
TWO

EQUUS BAR

With its eclectic fabrics and decor, Equus Bar recreates the 'gentlemen's club' atmosphere of the hotel's past, yet with great modern vibrancy. It celebrates our rich history with a range of contemporary cocktails named after famous former guests, including George Bernard Shaw and Sir Winston Churchill, complementing our extensive list of classic drinks. All suitably matched by a creative, modern British food menu.







ACCOMMODATION AND SUITES















The high ceilings, sumptuous furnishings and full air conditioning make all rooms at The Royal Horseguards the perfect luxurious retreat. Many have stunning views over the River Thames. The bedrooms are equipped to meet the needs of the most discerning business and leisure traveller, with vanity sets, iPod docking stations, Bose surround sound and wonderful Egyptian cotton bed linen. Even the room safe has a built-in plug socket to charge your laptop, while keeping it secure.

Every room at The Royal Horseguards has plasma TVs in the bedroom and bathroom, international plug sockets and free wifi. For a truly unique five-star experience, choose one of our five signature suites. Each has been conceived with its own individual style, décor and ambiance.

Whether you are in London for a business conference or for leisure, The Royal Horseguards offers genuine luxury and a memorable experience.

ONE WHITEHALL PLACE

KEY

-  3 Phase Supply
-  Facility Panel
-  Audio Visual Access Panel
-  Audio Visual Access Panel with extra power
-  Square pillar
-  Round pillar square base
-  Dance Floor
-  Ceiling Height
-  Height Below Chandelier
-  Sky Hook
-  Chandelier and Sky Hook
-  Chandelier
-  Projector Panel
-  Kick Point
-  Umbilical Floor Box

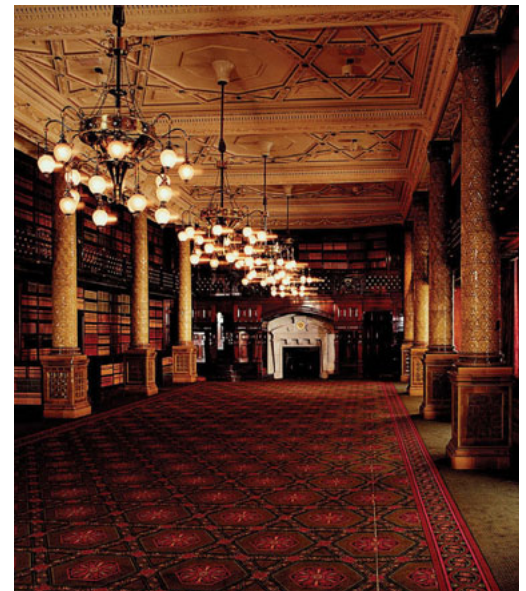



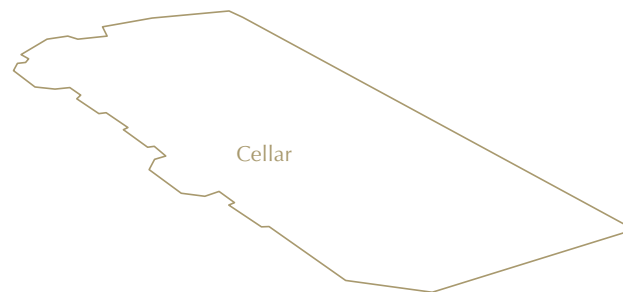
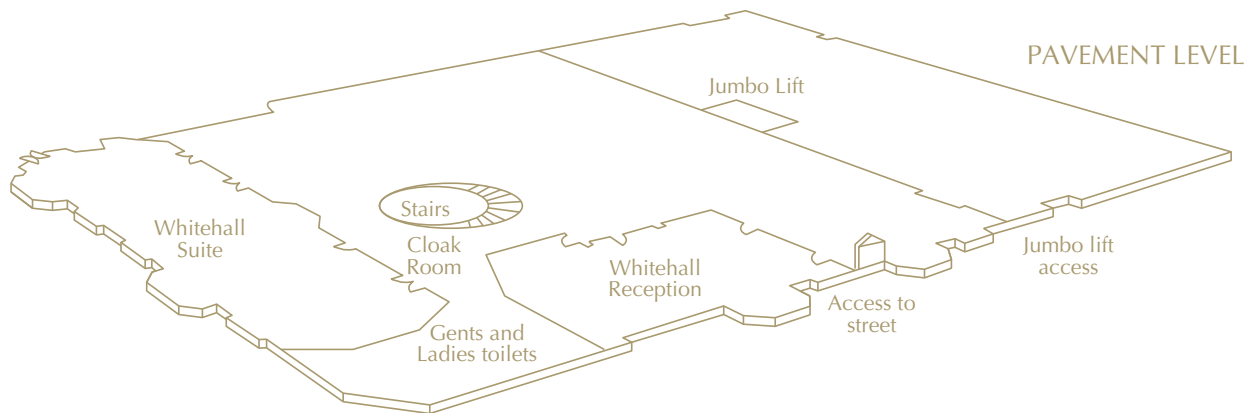
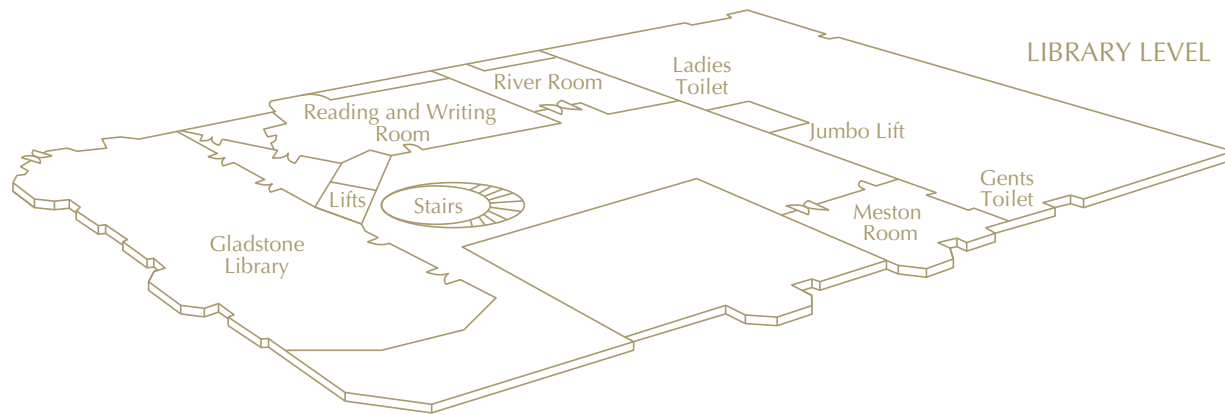











	Room Dimensions (metres)
Gladstone Library	27.79 x 7.71 (7.00 high)
Reading and Writing Room	21.90 x 10.60 (7.00 high)
The River Room	10.20 x 10.57 (6.45 high)
The Meston Suite	10.62 x 8.16 (6.50 high)
The Whitehall Suite	27.53 x 11.10 (7.00 high)
The Whitehall Reception	17.65 x 10.75 (2.76 high)
The Cellar	-
Churchill Bar	10.89 x 9.81 (6.50 high)



THE ROYAL HORSEGUARDS HOTEL

KEY

-  3 Phase Supply
-  Facility Panel
-  Audio Visual Access Panel
-  Audio Visual Access Panel with extra power
-  Square pillar
-  Round pillar square base
-  Dance Floor
-  Ceiling Height
-  Height Below Chandelier
-  Sky Hook
-  Chandelier and Sky Hook
-  Chandelier
-  Projector Panel
-  Klick Point
-  Umbilical Floor Box

	Room Dimensions (metres)
The Executive Boardroom	5.35 x 5.63 (2.5 high)
The Thames Suite	9.50 x 5.23 (2.35 high)
The Chelsea Suite	11.66 x 4.70 (2.77 high)
The Waterloo Suite	5.25 x 5.20 (2.80 high)
The London Room	8.50 x 4.70 (2.80 high)
The Terrace Room	9.60 x 6.00 (2.43 high)





THE ROYAL HORSEGUARDS HOTEL
ONE WHITEHALL PLACE



The Royal Horseguards Hotel & One Whitehall Place, 2 Whitehall Court, London SW1A 2EJ

T: 020 7839 3400 F: 020 7839 3366 E: royalhorseguards@guoman.co.uk

W: www.theroyalhorseguards.com

Meetings & Events Office

T: 020 7451 9386 F: 020 7839 3366 E: onewhitehallplace@guoman.co.uk



WWW.GUOMAN.COM